



**U790**  
Recessed Shelf

Revision 05/14

JOB #:

ITEM #:

QUANTITY:

MOUNTING	HANDING	TYPE	SIZE	OTHER

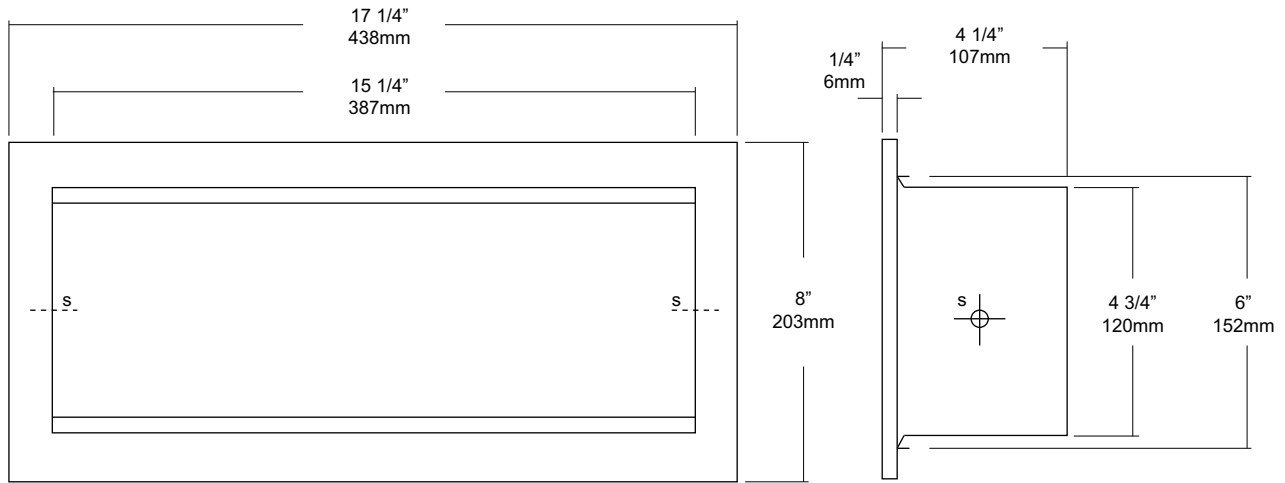

**SPECIFICATIONS**

**Recessed Shelf:** Fabricated of #22 gauge stainless steel. Face trim is an integral part of the body and of one piece construction without miters or welds. Returns are 1/4" to wall surface for maximum strength and rigidity.

**Overall Size:** 17 1/4"W x 8"H x 4 1/4"D

**438mm X 203mm X 107mm**

**Opening:** 15 3/4"W x 6 1/2"H x 4"D

**400mm x 165mm x 101mm**

**INSTALLATION**

Coordinate opening with architect or contractor to avoid interference with pipes, vents, etc. Provide wall opening 15 3/4"W x 6 1/2"H x 4"D. Insert shelf into opening and secure with proper fasteners (not provided) per application.

**NOTES**